



GENERAL CHARACTERISTICS

- Nominal content: 150, 200, 250 and 300 litre
- Kettle bowl in 316 acid resistant steel, all other parts in 304 stainless steel
- Full welded, insulated kettle body with etched volume markings
- Working pressure: 1,0 bar
- Max. steam temperature: 120° C
- Adjustable, vertical control box with IPX6 protection class
- Integrated isolator switch
- Pressure gauge
- Tilting height: Min. 600 mm from floor to bottom of pouring lip
- Unheated top for lower energy waste and better comfort
- Hinged easy open/close lid with gas-spring and ergonomic lid arm
- Lid made from stainless steel
- Safety device to prevent tilting with a closed lid
- Electric tilt with adjustable TiltBack
- Error codes for user errors and appliance faults
- Maximum temperature on the outside of the kettlebowl after 3 hours cooking: <40°C
- Working height: 900 mm
- Spray gun

CONTROL AUTO TEMP 32

- Electronic control of the jacket temperature
- Timer for cooking time/hour
- Clock
- Electronic water flow meter with drip-free spout
- Access code can be selected
- Two sets of arrow keys for fast, precise setting

OPTIONS

- Connection for Power-Management-System
- Rotatable lid
- Drain valve/ Butterfly valve

VARIANTS

- Can be built together with Multi, MultiMix and OptiMix
- Mounting pillar to the left

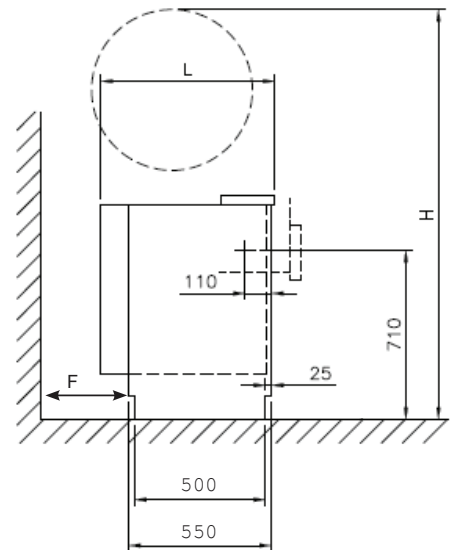
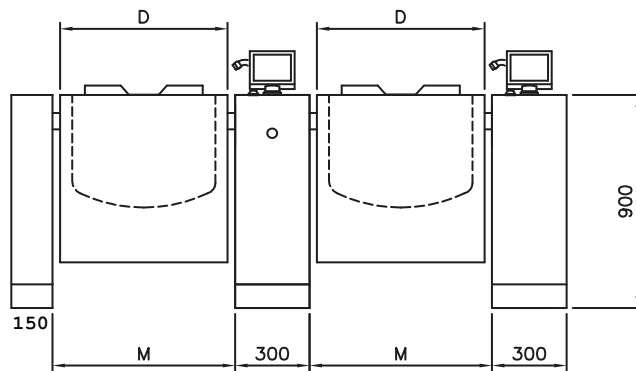
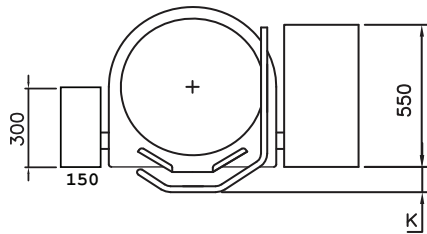

Product Code	Type	Dimensions								Direct Steam Version 3AC 400V 50Hz			Water		
		C (mm)	D (mm)	H (mm)	K (mm)	L (mm) 750 pillar	M (mm)	F (mm)	Nom/brim volume (L)	Weight (kg)	Steam consumption (kg/h) when the time to reach boiling point (10-90°C) is 20 min.	Rated Power (kW)	Current consumption (A)	COLD	HOT
AU101011	Opti 150	20	792	1944	125	832	892	315	150/169	393	72	0.37	3x0.7	1/2", 1.5-6 bar	1/2", 1.5-6 bar
AU101013	Opti 200	20	842	1971	125	882	942	396	200/222	422	96	0.37	3x0.7		
AU101015	Opti 250	20	940	2050	125	980	1040	471	250/278	514	120	0.37	3x0.7		
AU101017	Opti 300	20	1040	2130	125	1080	1140	549	300/334	574	144	0.37	3x0.7		

SPECIFICATIONS ARE SUBJECT TO CHANGE WITHOUT NOTICE. Drawing and mounting can not be made from these data alone. Further measurements, other voltages and connections and information about electrics, water, steam, compressed air and special conditions regarding leakage current is available in the complete technical data.